

HPE ProLiant DL180 Gen9 Server

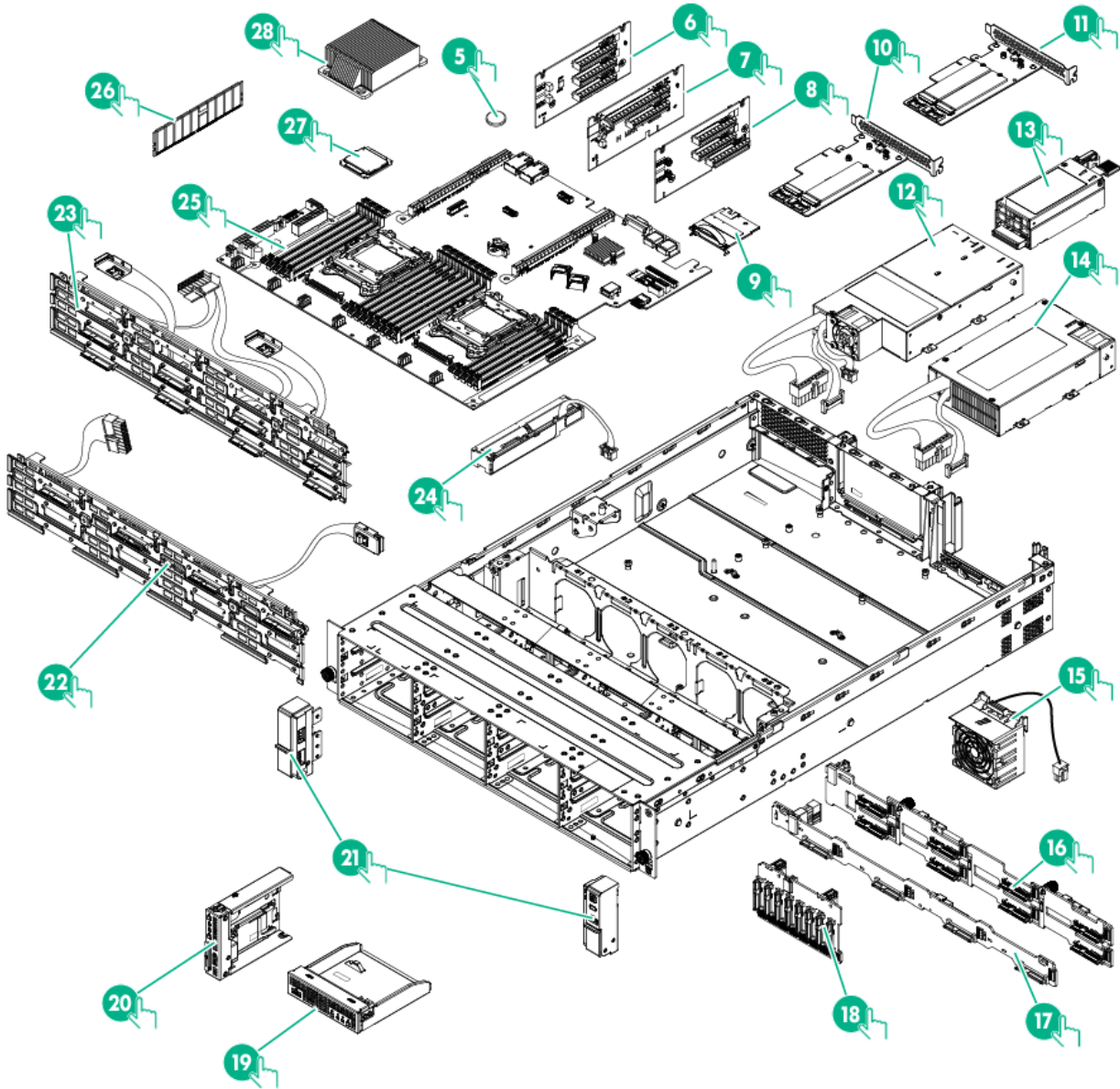

System components



Item	Description	Spare part number	Customer self repair
5	System battery	319603-001	Mandatory ¹
6	Three-slot PCIe riser board	779085-001	Mandatory ¹

7	Two-slot PCIe riser board	779084-001	Mandatory ¹
8	FlexibleLOM riser board	794360-001	Mandatory ¹
9	Dedicated iLO management module	779095-001	Mandatory ¹
10	SATA M.2 SSD single module enablement kit	797907-001	Optional ²
	a) M.2 SSD enablement board	—	—
	b) M.2 SSD module	—	—
	c) SATA cable*	—	—
	d) Low-profile board bracket*	—	—
11	SATA M.2 SSD dual module enablement kit	797908-001	Optional ²
	a) M.2 SSD enablement board	—	—
	b) M.2 SSD modules (2)	—	—
	c) SATA cables (2)	—	—
	d) Low-profile board bracket*	—	—
12	RPS backplane assemblies	—	—
	a) AC RPS backplane assembly	784636-001	Optional ²
	b) AC/240 V DC RPS backplane assembly*	830022-001	Optional ²
13	Hot-plug power input modules	—	—
	a) HPE 800 W/900 W Gold AC Power Input Module	754376-001	Mandatory ¹
	b) HPE 900 W AC/240 V DC Gold Power Input Module	830219-001	Mandatory ¹
14	HPE 550 W Power Supply (non-hot-plug)	766879-001	Optional ²
15	Hot-swap fan	779093-001	Mandatory ¹
16	8-bay LFF hot-plug drive backplane	779083-001	Optional ²
17	4-bay LFF hot-plug drive backplane	779096-001	Optional ²
18	8-bay SFF hot-plug drive backplane	780971-001	Optional ²
19	Front I/O assembly for LFF chassis using thumbscrew rack ears	779088-001	Optional ²
20	Front I/O assembly for SFF chassis using thumbscrew rack ears	779089-001	Optional ²
21	Quick-release latch rack ear assembly	779090-001	Optional ²
22	4-bay LFF non-hot-plug drive cable assembly (includes Mini-SAS and drive power cables)	782466-001	Mandatory ¹
23	8-bay LFF non-hot-plug drive cable assembly (includes Mini-SAS and drive power cables)	782458-001	Mandatory ¹
24	Smart Storage Battery	815983-001	Mandatory ¹
25	System boards (include alcohol pad and thermal compound)	—	—
	a) System board for Intel Xeon E5-2600 v3 processors	779094-001	Optional ²
	b) System board for Intel Xeon E5-2600 v3 and v4 processors	848082-001	Optional ²
26	DIMMs	—	—
	DIMMs optimized for the Intel Xeon E5-2600 v3 processors		
	a) 4 GB, single-rank x8 PC4-2133P-R	804842-001	Mandatory ¹
	b) 4 GB, single-rank x8 PC4-2133R-15*	774169-001	Mandatory ¹
	c) 8 GB, single-rank x4 PC4-2133R-15*	774170-001	Mandatory ¹
	d) 8 GB, single-rank x8 PC4-2133P-R*	804843-001	Mandatory ¹
	e) 8 GB, dual-rank x8 PC4-2133P-R*	774171-001	Mandatory ¹
	f) 16 GB, dual-rank x4 PC4-2133R-15*	774172-001	Mandatory ¹
	g) 16 GB, dual-rank x4 PC4-2133P-L*	774173-001	Mandatory ¹
	h) 32 GB, dual-rank x4 PC4-2133P-R*	774175-001	Mandatory ¹
	i) 32 GB, quad-rank x4 PC4-2133P-L*	774174-001	Mandatory ¹
	j) 64 GB, quad-rank x4 PC4-2133P-L*	774176-001	Mandatory ¹

	DIMMs optimized for the Intel Xeon E5-2600 v4 processors		
	a) 8 GB, single-rank x4 PC4-2400T-R*	819410-001	Mandatory ¹
	b) 16 GB, single-rank x8 PC4-2400T-R*	819411-001	Mandatory ¹
	c) 16 GB, dual-rank x4 PC4-2400T-R*	846740-001	Mandatory ¹
	d) 32 GB, dual-rank x4 PC4-2400T-R*	819412-001	Mandatory ¹
	e) 32 GB, dual-rank x4 PC4-2400T-L*	819414-001	Mandatory ¹
	f) 64 GB, quad-rank x4 PC4-2400T-L*	819413-001	Mandatory ¹
27	Processors (include alcohol pad and thermal compound)**	—	—
	Intel Xeon E5-2600 v3 processors		
	a) 1.60 GHz Intel Xeon E5-2603 v3, 6C, 85 W	762441-001	Optional ²
	b) 1.80 GHz Intel Xeon E5-2630L v3, 8C, 55 W*	762459-001	Optional ²
	c) 1.80 GHz Intel Xeon E5-2650L v3, 12C, 65 W*	762461-001	Optional ²
	d) 1.90 GHz Intel Xeon E5-2609 v3, 6C, 85 W*	762443-001	Optional ²
	e) 2.30 GHz Intel Xeon E5-2650 v3, 10C, 105 W*	762448-001	Optional ²
	f) 2.40 GHz Intel Xeon E5-2620 v3, 6C, 85 W*	762445-001	Optional ²
	g) 2.40 GHz Intel Xeon E5-2630 v3, 8C, 85 W*	762446-001	Optional ²
	h) 2.60 GHz Intel Xeon E5-2640 v3, 8C, 90 W*	762447-001	Optional ²
	i) 2.60 GHz Intel Xeon E5-2660 v3, 10C, 105 W*	762449-001	Optional ²
	j) 3.00-GHz Intel Xeon E5-2623 v3, 4C, 105 W*	780762-001	Optional ²
	Intel Xeon E5-2600 v4 processors		
	a) 1.70 GHz Intel Xeon E5-2603 v4, 6C, 85 W	835599-001	Optional ²
	b) 1.70 GHz Intel Xeon E5-2609 v4, 8C, 85 W*	835600-001	Optional ²
	c) 1.70 GHz Intel Xeon E5-2650L v4, 14C, 65 W*	835609-001	Optional ²
	d) 1.80 GHz Intel Xeon E5-2630L v4, 10C, 55 W*	835608-001	Optional ²
	e) 2.00 GHz Intel Xeon E5-2660 v4, 14C, 105 W	835605-001	Optional ²
	f) 2.10 GHz Intel Xeon E5-2620 v4, 8C, 85 W*	835601-001	Optional ²
	g) 2.10 GHz Intel Xeon E5-2683 v4, 16C, 120 W*†	835614-001	Optional ²
	h) 2.10 GHz Intel Xeon E5-2695 v4, 18C, 120 W*†	835615-001	Optional ²
	i) 2.20 GHz Intel Xeon E5-2630 v4, 10C, 85 W*	835602-001	Optional ²
	j) 2.20 GHz Intel Xeon E5-2650 v4, 12C, 105 W*	835604-001	Optional ²
	k) 2.40 GHz Intel Xeon E5-2640 v4, 10C, 90 W*	835603-001	Optional ²
	l) 2.40 GHz Intel Xeon E5-2680 v4, 14C, 120 W*†	835606-001	Optional ²
	m) 2.60 GHz Intel Xeon E5-2623 v4, 4C, 85 W*	835610-001	Optional ²
28	Heatsink	779091-001	Optional ²
29	System cables	—	—
	a) 4-bay LFF hot-plug Mini-SAS cable for connection to the onboard storage controller or to an HPE H-series Host Bus Adapter*	782464-001	Mandatory ¹
	b) 4-bay or 12-bay LFF hot-plug Mini-SAS cable for an HPE Smart Array P-series Controller*	782465-001	Mandatory ¹
	c) 8-bay LFF hot-plug Mini-SAS cable assembly*	782459-001	Mandatory ¹
	d) 8-bay LFF hot-plug Mini-SAS Y-cable*	782460-001	Mandatory ¹
	e) 12-bay LFF drive identification signal cable*	782467-001	Mandatory ¹
	f) 8-bay SFF hot-plug Mini-SAS cables*	782461-001	Mandatory ¹
	g) 8-bay SFF hot-plug Mini-SAS Y-cable*	782462-001	Mandatory ¹
	h) 20-pin power cable for LFF drive models*	782455-001	Mandatory ¹
	i) 20-pin power cable for SFF drive models*	782453-001	Mandatory ¹
	j) Optical drive SATA cable*	782457-001	Mandatory ¹
	k) GPU power cable*	782456-001	Mandatory ¹
	l) FlexibleLOM sideband signal cable*	789801-001	Mandatory ¹
30	Trusted Platform Module*	—	—

a) TPM 1.2*	505836-001	No ³
b) TPM 2.0*	812119-001	No ³

*Not shown

**All processors in this HPE ProLiant server must have the same cache size, speed, number of cores, and rated maximum power consumption.

†Intel Xeon E5-2600 v4 processors with a TDP higher than 105 W are only supported in the system board spare 848082-001.

¹Mandatory—Parts for which customer self repair is mandatory. If you request Hewlett Packard Enterprise to replace these parts, you will be charged for the travel and labor costs of this service.

²Optional—Parts for which customer self repair is optional. These parts are also designed for customer self repair. If, however, you require that Hewlett Packard Enterprise replace them for you, there may or may not be additional charges, depending on the type of warranty service designated for your product.

³No—Some Hewlett Packard Enterprise parts are not designed for customer self repair. In order to satisfy the customer warranty, Hewlett Packard Enterprise requires that an authorized service provider replace the part. These parts are identified as "No" in the Illustrated Parts Catalog.